

MEETING & BANQUET CAPACITIES

NAME/LOCATION	SIZE	SQ. FT.	MAXIMUM CAPACITY PER SET-UP STYLE					
			Buffet	Banquet	Reception	Classroom	Theater	Conference
Blackberry Hall								
North Hall	36' x 60'	1920'	100	100	125	75	125	50
South Hall	36' x 40'	1280'	60	60	80	50	60	30
Combined	36' x 100'	3200'	175	175	225	125	200	70
Ballroom (Main Lodge)	36' x 68'	2450'	128	128	128	90	200	50
Barley Room (Main Lodge)	21' x 27'	570'	40	40	40	24	40	28
Mt. Hood Room (Main Lodge)	14' x 22'	300'	24	24	24	-	-	16
Red Fox Room (Main Lodge)	14' x 18'	252'	-	12	-	-	-	12
Vintner's Room (Main Lodge)	14' x 18'	252'	-	12	-	-	-	12
Bullfrog Room (Main Lodge)	13' x 14'	180'	-	8	-	-	-	8
Study (Main Lodge)	27' x 19'	513'	-	-	15	-	-	12
Winery (Main Lodge)	45' x 8'	360'	25	-	15	-	-	-
Attic (Power Station)	33' x 69'	2500'	120	-	120	50	50	30
Theater (Power Station)	26' x 42'	1100'	40	-	50	50	125	40
Annex (Power Station)	22' x 26'	510'	-	40	40	-	-	-
House & Side Yard (Administrator's House)	-	1182'	100	-	100	-	-	-
Meadow	-	6175'	200	-	200	-	-	-
Fir Grove (SE Corner)	-	4175'	125	-	125	-	-	-

For more information, please call to speak with an event coordinator at the Edgefield Sales Office:
(503) 492-2777 or (877) 492-2777.

SITE PLANS

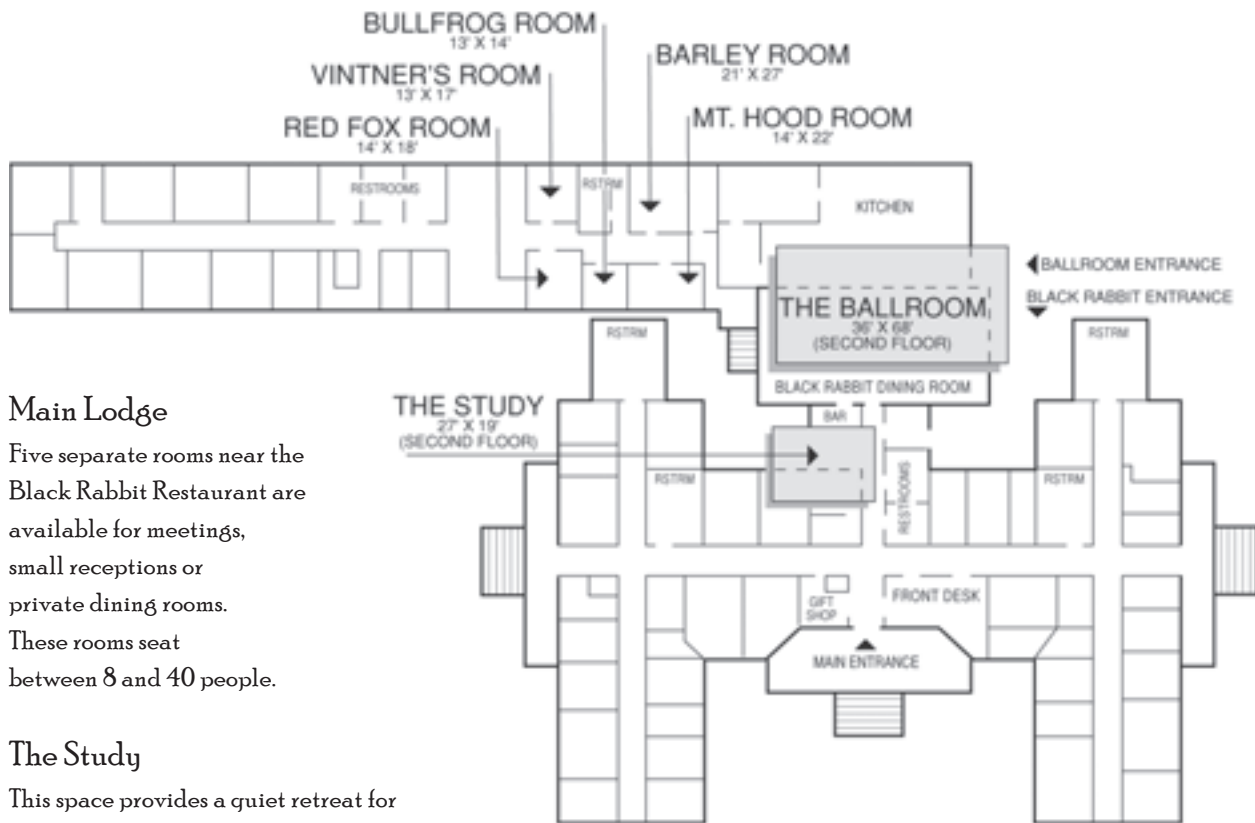

Main Lodge

Five separate rooms near the Black Rabbit Restaurant are available for meetings, small receptions or private dining rooms. These rooms seat between 8 and 40 people.

The Study

This space provides a quiet retreat for 12-15 people. Vintage sofas and chairs along with a small conference table make it a cozy, casual room.



The Ballroom

This space was originally both the chapel and recreation room during the Poor Farm era. Located on the second floor of the Main Lodge, it is not only a grand and spacious banquet room but a masterpiece in itself.

Numerous windows allow plenty of natural light to set off the the hand painted mural on the wall. The Ballroom is an ideal place for a memorable banquet, reception or conference.

Because of its location above our restaurant, we do not allow dancing or amplified music in the Ballroom.

SITE PLANS

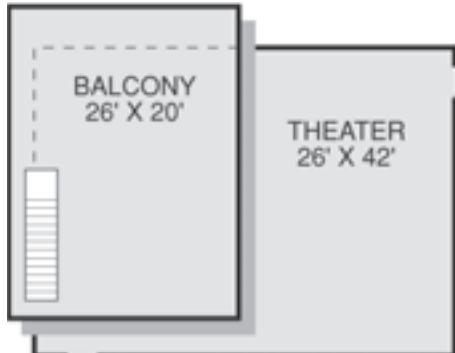

The Power Station offers a variety of meeting facilities located throughout this classic building.

The Theater has a beautifully ornate ceiling and is well suited for meetings, receptions or wedding ceremonies.

The Annex is an enclosed dining area set off the main pub and provides the perfect setting for a private lunch or dinner.

The Attic is a spacious yet cozy room perfect for banquets and receptions.

Hardwood floors and open beams lend a cozy appeal.

Alcoves at each side of the room let in natural light.

Please note, the attic is not ADA accessible.



SITE PLANS

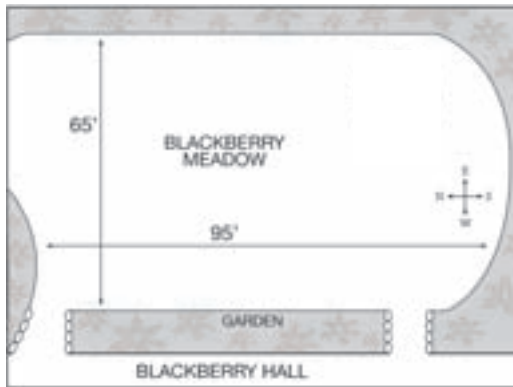

Blackberry Meadow

Adjacent to Blackberry Hall, this well-manicured location is ideal for ceremonies and outdoor receptions.

Available seasonally, this space is only booked in conjunction with Blackberry Hall

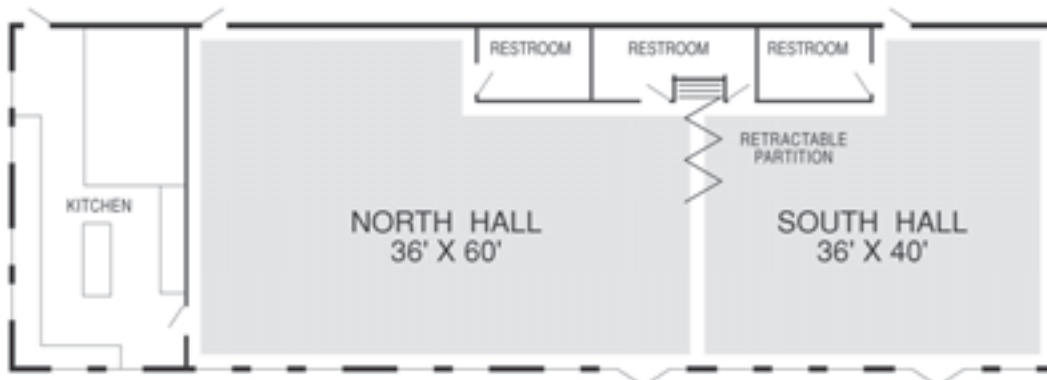

Blackberry Hall

Originally built for storage in the 1960s, the building has been transformed into Edgefield's largest banquet space. Uphill from Power Station Pub, Blackberry Hall sits on a small hill facing west.

The spot is perfect for larger banquets, wedding receptions, class reunions, dinner dances, conferences and exhibits. The divider wall creates two function rooms for groups desiring alternate meeting and dining space or breakout rooms.

SITE PLANS



The Administrators House

The original Administrator's home of the Multnomah County Poor Farm is a delightful backdrop for small weddings, receptions and intimate parties in the side courtyard.

Booking six guestrooms in the house is a wonderful way to ensure private use of the living room and porch

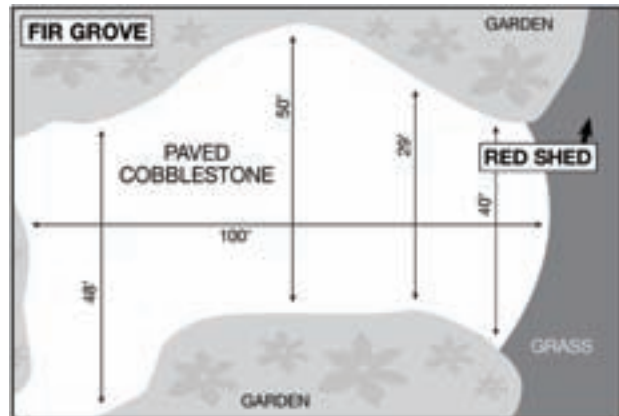

The Little Red Shed & Fir Grove

Once the incinerator for the Old Poor Farm, the Little Red Shed still has a fireplace with its interior iron doors still intact.

The Shed is a quaint backdrop adjacent to the Fir Grove where guests can gather surrounded by towering trees and landscaped gardens.

